

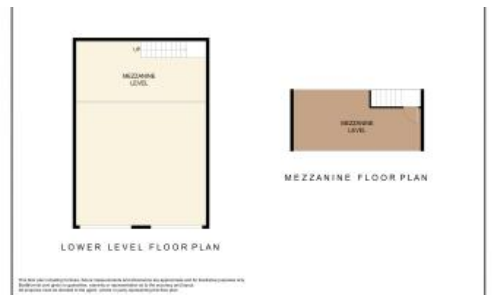

Unit 2, 17 Sherwood Rd, Bermagui



Strata Titled Industrial Shed @ Bermagui

Unit 2/17 Sherwood Rd - Bermagui - Strata Title Storage/Industrial Shed in heart of the Industrial Estate at Bermagui.

Ideal for trades people who are looking for extra storage, or to park your large boat, trailer or other valuable items.

Shed Size: 10.7 metres deep x 7.5 metres wide.

Mezzanine Floor: Open plan.

Outside: Shared use of the land which is fully fenced plus an outside toilet.

GST: Maybe Subject to GST (to be confirmed).

Inspections: Phone Dee Cramb 0421 748 610 for a private inspection.

NOTE: This is an industrial unit and cannot be used for residential purposes.

The above information provided has been furnished to us by the vendor/s. We have not verified whether or not that information is accurate and do not have any belief in one way or the other in its accuracy. We do not accept any responsibility to any person for its accuracy and do no more than pass it on. All interested parties should make and rely upon their own inquiries in order to determine whether or not this information is in fact accurate.

Price	\$399,000
Property Type	Commercial
Property ID	540
Office Area	30 m2
Warehouse Area	70 m2

Agent Details

Dee Cramb - 0421 748 610

Office Details

Clearwater Real Estate - Narooma
02 4476 4449

